

291 Lake Mike Conner

WRD Exp. (GW)
April 1966

Well No. G3

WELL SCHEDULE

U. S. DEPT. OF THE INTERIOR GEOLOGICAL SURVEY WATER RESOURCES DIVISION

MASTER CARD

Record by P.E. Grantham Source of data owner Date 6-22-66 Map County

State Mississippi 28 County (or town) Jeff Davis 33

Latitude: 31 31 22 N Longitude: 08 94 20 0 Sequential number: 1

Lat-long accuracy: 2 T. 7 S, R 17 Sec 34, SW 1/4, SE 1/4

Local well number: 4003DC3407N17W Other number: _____ B & M

Local use: _____ Owner or name: Clara Campbell

Owner or name: Clara CAMPBELL Address: _____

Ownership: County, Fed Gov't, City, Corp or Co, Private, State Agency, Water Dist P

Use of water: (A) Air cond, Bottling, Comm, Dewater, Power, Fire, Dom, Irr, Med, Ind, P S, Rec, (S) Stock, Inacit, Unused, Repressure, Recharge, Desal-P S, Desal-other, Other H

Use of well: (A) Anode, Drain, Seismic, Heat Res, Obs, Oil-gas, Recharge, Test, Unused, Withdraw, Waste, Destroyed W

DATA AVAILABLE: Well data Freq. W/L meas.: None N Field aquifer char.

Hyd. lab. data: _____

Qual. water data; type: Complete Chemical Anal.

Freq. sampling: Original Pumpage inventory: period: _____

Aperture cards: _____

Log data: _____

WELL-DESCRIPTION CARD

SAME AS ON MASTER CARD Depth well: 90 ft 90 Meas. rept accuracy 6

Depth cased: 85 ft 85 Casing type: Plastic; Diam. 2 in 2

Finish: porous gravel w. gravel w. horiz. open perf., screen, sd. pt., shored, open hole, other S

Method Drilled: (A) air bored, cable, dug, hyd jetted, air reverse trenching, driven, drive wash, other H

Date Drilled: 1966 066 Pump intake setting: _____ ft _____

Driller: Dean Grimes, Columbia Miss.

Lift (type): (A) air, bucket, cent, jet, multiple, multiple, none, piscon, rot, submerg, turb, other J Deep Shallow

Power (type): diesel, elec, gas, gasoline, hand, gas, wind; H.P. 1/2 T Trans. or meter no. _____

Descrip. MP none ft above below LSD, Alt. MP _____

Alt. LSD: 362 Accuracy: (source) _____

Water Level: _____ ft above below MP; Ft below LSD _____ Accuracy: _____

Date meas: _____ Yield: _____ gpm _____ Method determined _____

Drawdown: _____ ft _____ Accuracy: _____ Pumping period _____ hrs _____

QUALITY OF WATER DATA: Iron 0.09 1 Sulfate 0.6 0 Chloride 3.1 0 Hard. 9 0

Sp. Conduct 40 K x 10⁶ 0 Temp. 70 °F 70 Date sampled 12-27-66 066

Taste, color, etc. _____

TRANSMITTED FOR ADP

Well No.

G3

Latitude-longitude N
S
d m s d m s

HYDROGEOLOGIC CARD

SAME AS ON MASTER CARD Physiographic Province: Coastal Plain 03 Section: East Gulf Coastal

Plain d Drainage Basin: 13N Subbasin: 26

Topo of well site: (D) depression, stream channel, dunes, flat, hilltop, sink, swamp, (E) (F) (H) (K) (L) (M) (N) (O) (P) (S) (T) (U) (V) offshore, pediment, hillside, terrace, undulating, valley flat 27

MAJOR AQUIFER: Tertiary system Pliocene series TP Citronelle aquifer, formation, group C:1

Lithology: Gravelly sand 9S Origin: Fluvial 2 Aquifer Thickness: ft

Length of well open to: 5 ft 5 Depth to top of: ft

MINOR AQUIFER: system series aquifer, formation, group

Lithology: Origin: Aquifer Thickness: ft

Length of well open to: ft Depth to top of: ft

Intervals Screened: 85-90 ft 5' plastic

Depth to consolidated rock: ft Source of data:

Depth to basement: ft Source of data:

Surficial material: Infiltration characteristics:

Coefficient Trans: gpd/ft Coefficient Storage:

Coefficient Perm: gpd/ft²; Spec cap: gpm/ft; Number of geologic cards:

Basin ←

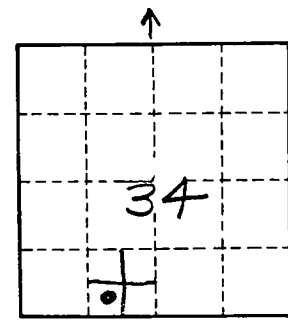
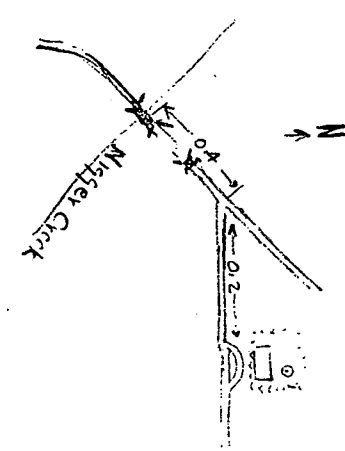

Well No. G 3